

Helping Your Community Be Successful



Community and Economic Development



Georgia Power has been helping communities grow and prosper for more than 80 years. Our Community & Economic Development organization offers a wide range of products and services to help your community be successful. With an international reputation for excellence in customer service, reliability, innovative solutions to energy issues and economic development, Georgia Power continues to develop new and better ways of serving our customers and our communities. Here are some of our services:

Community Development

- Assistance with business recruitment, existing industry expansions and retention of local companies
- Custom presentations
- Assistance with marketing materials
- Hosting local leadership groups in the Georgia Resource Center
- Help with leadership training
- Facilitate short-term and long-term strategic planning sessions
- Advice on infrastructure improvements

Economic Development

- Total project management for manufacturing, corporate and regional headquarters, warehouse/distribution, R&D, bio science, data centers and back office operations
 - Site and community tours
 - Liaison with local leadership
 - Access to state and local incentives
 - Scheduling of existing employer interviews
 - Liaison with colleges, universities, and technical colleges



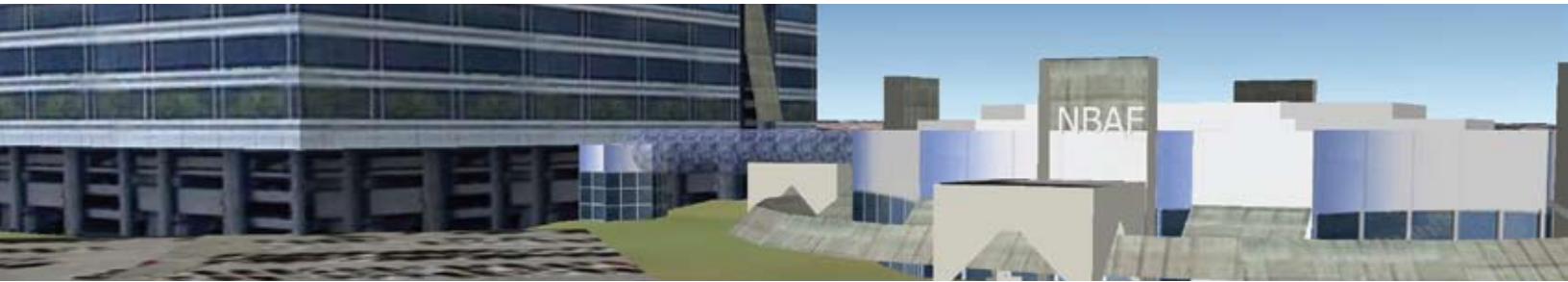

Engineering

- Business and industrial park planning
- Engineering evaluation and site analysis
- Preliminary site plans and designs
- Infrastructure analysis: electrical, water, sewer, telecom
- Soil and air (non-attainment) analysis
- Floods and wetlands analysis
- Building renderings
- Virtual 3-D building construction
- Interactive maps and floor plans
- GIS analysis and custom mapping



Research

- Demographic and business data for economic development projects
- Workforce analysis
- Industry-specific research and in-depth reports
- Market and supplier analysis
- Customized city and state comparisons
- Custom maps and graphics



SelectGeorgia.net



One of Georgia Power's greatest resources is SelectGeorgia.net, our new on-line site selection system that includes a database of available sites and buildings, as well as community information.

In addition to the building and site search, there are many new features such as aerial photography coverage of the entire state of Georgia — 100%, not just some areas — and interactive mapping tools, such as measuring, pan/zoom, red-lining and bird's-eye-view options.

There is extensive information on demographics, taxes, incentives, wage and salary information, and transportation infrastructure, and many other issues that are important to prospects in evaluating possible locations.

One of the most important benefits of our new on-line system is that communities can now examine information about their buildings and sites as it is viewed by site selection professionals. Any discrepancies or inaccuracies can be easily identified and corrected at any time. Local leaders can help us ensure the data is accurate and up-to-date by reviewing their properties on a regular basis and letting us know when changes are needed. At Georgia Power, we want your community to be successful — we look forward to seeing you grow and prosper — and through SelectGeorgia, you can help us help you!

Business Comparison: Georgia, Florida, North Carolina and South Carolina	Georgia	Florida	North Carolina	South Carolina
Population and Labor Force:				
Population (2007)	9,643,098	19,201,213	9,046,206	4,421,763
Projected Population (2012)	10,743,006	21,311,939	9,871,032	4,744,006
Annual Population Growth Rate (2007 to 2012)	2.34%	2.44%	1.72%	1.49%
Median Age (2007)	37	37	37.3	37.4
Labor Force Size (Region 2007)	4,638,754	9,288,280	4,348,486	2,134,848
Unemployment Rate (August 2007)	6.7%	6.7%	6.7%	6.7%
General Tax:				
Health Insurance Rate	\$6,300	\$7,000	\$7,000	\$7,000
State Employees' Tax Rate (based on monthly report)	2.7%	2.7%	2.7%	2.7%
Supplemental Employees' Tax Rate (based on monthly report)	1.9%	1.9%	1.9%	1.9%
State Income Tax Rate (based on monthly report)	5.9%	5.9%	5.9%	5.9%
Business (Compensation) Comparative Costs (All Items) (2007) (2008)				
Business (Compensation) Comparative Costs (All Items) (2007)	18.1%	18.1%	18.1%	18.1%
Business (Compensation) Comparative Costs (All Items) (2008)	18.1%	18.1%	18.1%	18.1%
Business (Compensation) Comparative Costs (All Items) (2007) (2008)				
Business (Compensation) Comparative Costs (All Items) (2007)	18.1%	18.1%	18.1%	18.1%
Business (Compensation) Comparative Costs (All Items) (2008)	18.1%	18.1%	18.1%	18.1%



J. E. (Rope) Roberts

Region Community & Economic Development Manager

Rope can be reached at :

706-357-6521

Mobile:

706-499-6515

E-mail:

jerobert@southernco.com

Web site:

www.selectgeorgia.net

As Georgia Power's community and economic development manager in the Northeast Region, Mr. Roberts supports local communities through leadership development, strategic planning, existing industry retention and expansions, and with new companies considering an expansion or relocation to the area.

Rope's career at Georgia Power began in 1979 at Plant Vogtle in accounting. He held various positions in procurement, project management, and corporate communication. In 1989, Rope was named the director of the Terrors Visitors Center in Tallulah Falls, and in 1995 became the manager of region economic development for Northeast Georgia.

Rope serves on North Georgia College and State University's Business Advisory Council and is an instructor in the Georgia Academy for Economic Development. He is a member of the Georgia Economic Developers Association.

Mr. Roberts holds a Bachelor of Business Administration in Management from Augusta State University and a Bachelor of Education from Georgia Southern University. A native of Augusta, Rope lives in Clarkesville with his wife, Anne, a registered nurse. They have seven children, four of whom were adopted internationally. Rope's hobbies include reading, hiking, snow skiing, and golf.

Northeast Region



Georgia Power
1001 Prince Avenue
Athens, Georgia
30606



**Community &
Economic
Development**

GEORGIA POWER
A SOUTHERN COMPANY